



LICENSING (HEARING) SUB COMMITTEE

Date: FRIDAY, 11 AUGUST 2017

Time: 11.00 am

**Venue: COMMITTEE ROOMS, 2ND
FLOOR, WEST WING, GUILDHALL**

**APPLICANT:
BREWSKEE**

**PREMISES:
56 LEADENHALL STREET, LONDON,
EC3A 2DX**

CONTENTS

| | |
|--|-----------------|
| Hearing Procedure | (Pages 1 - 2) |
| Report of the Director of Markets & Consumer Protection | (Pages 3 - 8) |
| Appendix 1: Copy of Application | (Pages 9 - 32) |
| Appendix 2: Conditions consistent with the operating schedule | (Pages 33 - 34) |
| Appendix 3: Representations from Other Persons | |
| i) Chan | (Pages 35 - 36) |
| ii) Courtney | (Pages 37 - 38) |
| iii) Rees | (Pages 39 - 40) |
| iv) Whitby | (Pages 41 - 42) |
| Appendix 4: Map of subject premises together with other licensed premises in the area and their latest terminal time for alcohol sales | (Pages 43 - 44) |
| Appendix 5: Plan of Premises | (Pages 45 - 46) |

LICENSING (HEARING) SUB COMMITTEE PROCEDURE FOR PUBLIC HEARINGS

1. This procedure shall apply to all public hearings conducted under the provisions of the Licensing Act 2003.
2. Public hearings conducted under the provisions of the Licensing Act 2003 shall take the form of a discussion led by the licensing authority. Cross-examination will be permitted when the Sub Committee considers it to be required. The conduct of hearings shall be broadly based, subject to the discretion of the Sub Committee, on the points set out below.
3. At the start of the hearing the Chairman of the Sub Committee will introduce him/herself and other Members of the Sub Committee as well as the City Corporation officers present. Anyone making representations will then be asked to introduce themselves and anyone accompanying them. The applicant will then do likewise.¹
4. The Chairman will then explain the purpose of the hearing and the procedure to be followed at the hearing. The Sub Committee will then make any rulings necessary in respect of requests for witnesses to be heard in support of any of the parties making representations or the applicant.
5. Those making representations will then be invited to present their case. Repetition will not be permitted. Equal time will be offered to the applicant and those making representations. Where there is more than one party making representations and/or calling witnesses in support, consideration should be given to having one spokesman on behalf of all parties so as to avoid repetition. Although the use of a spokesman will be encouraged by the Sub Committee, the decision rests with those parties making representations.
6. In the event of disorder or persistent disregard of the authority of the Chair, the Chairman may suspend or adjourn the hearing, or require that the person(s) causing disorder or showing disregard leave the hearing.
7. In the event that the Sub Committee has decided that cross-examination will be permitted, the applicant will be invited to ask questions of the party(s) making representations and their witnesses (if any). The party(s) making representations and any witnesses giving evidence in support will then answer any questions put to them by members of the Sub Committee.
8. The applicant will then be invited to present their case and call any witnesses in support of their application. The applicant will be entitled to the same period of time to present his case as those making representations were afforded.

¹ In hearings where a licence is being reviewed, references in this procedure to 'applicant' should be read as references to the licence holder and references to 'those making representations' should be read as references to those applying for the review.

9. In the event that the Sub Committee has decided that cross-examination will be permitted, those making representations will be invited to ask questions of the applicant and their witnesses (if any). The applicant and any witnesses giving evidence in support will then answer any questions put to them by members of the Sub Committee.
10. The Chairman will ask all parties if there is anything else they would like to add in support of their respective cases.
11. Those making representations will then be invited to make closing submissions followed by the applicant.
12. The Sub Committee will then retire to consider their decision. They may call for assistance by the representatives of the Town Clerk and/or the Comptroller & City Solicitor but those persons will play no part in the decision-making process.
13. In due course, the Sub Committee will return to announce their decision or to inform those present when the decision will be given.

| | | |
|---|--|---------------------------------------|
| Committee(s): Licensing Sub-Committee | Hearing Date(s): 11 August 2017 | Item no. |
| Subject: Licensing Act 2003 - Application for a new premises license | | |
| Name of premises: Brewskee Address of premises: 56 Leadenhall Street, EC3A 2DX | | |
| Report of: Director of Markets and Consumer Protection | | Public / Non-Public |
| Ward (if appropriate): Aldgate | | |

1 Introduction

- 1.1 To consider and determine, by public hearing, the application for a new premises license under the Licensing Act 2003, taking into account the representations of ‘other persons’ detailed in paragraph 5, and the policy considerations detailed in paragraph 6 of this report.
- 1.2 The decision of the Sub-Committee must be made with a view to promoting one or more of the four licensing objectives, namely:
 - the prevention of crime and disorder
 - public safety
 - the prevention of public nuisance
 - the protection of children from harm

2 Summary of Application

- 2.1 An application made by:
Brewskee Ltd
64 New Cavendish Street
London
W1G 8TB

was received by the City of London Licensing Authority on 21 June 2017 for a new premises licence in respect of the premises at:

**56 Leadenhall Street
EC3A 2DX**

2.2 Full details of the application are contained in the copy of the Application Form at Appendix 1.

2.3 The application is to provide the following activities:

| <u>Activity</u> | <u>Current Licence</u> | <u>Proposed</u> |
|----------------------------|------------------------|---|
| Supply of Alcohol | N/A | Mon–Wed 11:00 – 01:00 Thu–Sat 11:00 – 02:00 Sun 11:00 – 00:00 |
| Late Night Refreshment | N/A | Mon–Wed 23:00 – 01:00 Thu–Sat 23:00 – 02:00 Sun 23:00 – 00:00 |
| Live Music. Recorded Music | N/A | Mon–Wed 23:00 – 01:00 Thu–Sat 23:00 – 02:00 Sun 23:00 – 00:00 |

2.4 The premises will be open to the public between 07:00 and 01:30 Mon to Wed, 07:00 and 02:30 Thu to Sat and 07:00 to 00:30 on Sunday.

2.5 The supply of alcohol is for on the premises only.

2.6 The Operating Schedule submitted by the applicant suggests a number of steps intended to be taken in order to promote the four licensing objectives. Those conditions which are consistent with the operating schedule and could be included on the licence are attached as Appendix 2.

2.7 The mandatory licence conditions can be found in the Licensing Act 2003, sections 19-21. Also, in the Schedules to The Licensing Act 2003

(Mandatory Licensing Conditions) Order 2010 (as amended) and The Licensing Act 2003 (Mandatory Conditions) Order 2014.

3 Licensing History of Premises

- 3.1 The premises is intended to trade as an indoor games facility with bars and provision for food.

Complaints

- 3.2 Not applicable as premises not yet trading.

4 Representations from Responsible Authorities

- 4.1 There are no representations from responsible authorities.

5 Representations From Other Persons

- 5.1 There are four representations from ‘other persons’. The representations are against the granting of the licence on the basis that if granted it will lead to the licensing objective of ‘the prevention of public nuisance’ being undermined. The representations can be seen in full as Appendix 3(i) to 3(iv).

6 Policy Considerations

- 6.1 In carrying out its licensing functions, the Licensing Authority must have regard to its Statement of Licensing policy and statutory guidance issued under s 182 of the Licensing Act 2003.

City of London Corporation’s Statement of Licensing Policy

- 6.2 The following sections/paragraphs of the City of London Corporation’s Statement of Licensing Policy are particularly applicable to this application.

Paragraphs 27 and 75 state that residents have a reasonable expectation that their sleep will not be unduly disturbed between the hours of 23:00 and 07:00.

The boxed comment on page 19 states the need to strike a fair balance between the benefits to a community of a licensed venue, and the risk of disturbance to local residents and workers.

The boxed comment on page 19 also states an overriding policy principle namely, that each application will be decided on its individual merits.

Paragraphs 79 – 81 address the need of care when controlling noise particularly from those persons leaving a premises.

The boxed comment on page 22 considers various factors that should be taken into account when considering whether any licensable activity should be permitted.

Paragraphs 115-121 state the Corporation's policy on setting conditions which may be applicable dependant on the step(s) taken by members as stated in paragraph nine of this report.

Statutory Guidance

- 6.3 The following sections/paragraphs of the statutory guidance issued under s182 of the Licensing Act 2003 are particularly applicable to this application (revised April 2017):

Chapter 2 of the guidance covers the four licensing objectives. In particular, paragraph 2.15 states that it is, '...important that in considering the promotion of *[the public nuisance licensing objective, licensing authorities]* focus on the effect of the licensable activities at the specific premises on persons living and working (including those carrying on business) in the area around the premises which may be disproportionate and unreasonable.' Also, paragraph 2.16 indicates that the prevention of public nuisance could, in appropriate circumstances include, 'the reduction of the living and working amenity and environment of other persons living and working in the area of the licensed premises.'

Chapter 10 refers to conditions attached to premises licences with paragraph 10.10 stating that, ‘Conditions should be determined on a case-by-case basis and standard conditions which ignore these individual aspects should be avoided.’ Also, ‘Licensing authorities should therefore ensure that any conditions they impose are only those which are appropriate for the promotion of the licensing objectives.’

7 Map and Plans

- 7.1 A map showing the location of the premises together with nearby licensed premises is attached at Appendix 4. A key of those premises is included which indicates the maximum permitted hours for alcohol sales or other licensable activity in respect of each premises.
- 7.2 Plans of the premises are attached as Appendix 5.

8 Summary

- 8.1 The Licensing Authority has a duty under the Licensing Act 2003 to promote the Licensing Objectives. Each objective has equal importance. In carrying out its licensing functions, the Licensing Authority must also have regard to its Statement of Licensing Policy, any Statutory Guidance under the Licensing Act 2003 and is bound by the Human Rights Act 1998. The Corporation must also fulfil its obligations under section 17 of the Crime and Disorder Act 1998 to do all that it reasonably can to prevent crime and disorder in the City.

9 Options

- 9.1 The Sub-committee must, having regard to the representations, take such of the following steps as it considers appropriate for the promotion of the licensing objectives:
- i) grant the licence subject to any conditions consistent with the operating schedule modified to such extent as the Sub-committee considers appropriate for the promotion of the licensing objectives and include the mandatory conditions contained in Ss. 19-21 of the Licensing Act 2003;
 - ii) exclude from the scope of the licence any of the licensable activities to which the application relates;

- iii) To refuse to specify a person in the licence as the premises supervisor;
- iv) Reject the application.

For the purposes of paragraph 9.1(i) conditions consistent with the operating schedule are modified if any of them are altered or omitted or any new condition is added.

9.2 Where a licensing authority takes one or more of the steps stated in paragraph 9.1 above the applicant, or the holder of the licence and/or a person who made relevant representations in relation to the application, may appeal the decision to the Magistrates' Court. Any appeal must be commenced within 21 days following notification of the decision to the appellant by the licensing authority.

10 Recommendation

10.1 It is therefore RECOMMENDED that your Sub-Committee determine this application for a premises licence in accordance with paragraph 9 of this report.

Prepared by P Davenport
 Licensing Manager
 peter.davenport@cityoflondon.gov.uk

Background Papers

| <u>BACKGROUND PAPER</u> | <u>DEPT</u> | <u>FILE</u> |
|--|-------------|------------------------------------|
| Corporation of London Statement of Licensing Policy (revised Jan 2017) | MCP | 5th Floor Walbrook Wharf |
| Statutory Guidance – 'Revised Guidance Issued Under Section 182 Of The Licensing Act 2003'. April 2017 | | Statutory Guidance |



**Application for a premises licence to be granted
under the Licensing Act 2003**

PLEASE READ THE FOLLOWING INSTRUCTIONS FIRST

Before completing this form please read the guidance notes at the end of the form. If you are completing this form by hand please write legibly in block capitals. In all cases ensure that your answers are inside the boxes and written in black ink. Use additional sheets if necessary.

You may wish to keep a copy of the completed form for your records.

I/We Brewskee Limited

(Insert name(s) of applicant)

apply for a premises licence under section 17 of the Licensing Act 2003 for the premises described in Part 1 below (the premises) and I/we are making this application to you as the relevant licensing authority in accordance with section 12 of the Licensing Act 2003

Part 1 – Premises details

| | | | |
|--|--------|-----------------|----------|
| Postal address of premises or, if none, ordnance survey map reference or description | | | |
| Brewskee 56 Leadenhall Street (former London Metal Exchange) | | | |
| Post town | London | Postcode | EC3A 2DX |

| | |
|---|------------------|
| Telephone number at premises (if any) | |
| Non-domestic rateable value of premises | £no longer rated |

Part 2 - Applicant details

Please state whether you are applying for a premises licence as Please tick as appropriate

- | | | |
|--|--------------------------|-----------------------------|
| a) an individual or individuals * | <input type="checkbox"/> | please complete section (A) |
| b) a person other than an individual * | | |
| i as a limited company/limited liability partnership | [✓] | please complete section (B) |
| ii as a partnership (other than limited liability) | <input type="checkbox"/> | please complete section (B) |
| iii as an unincorporated association or | <input type="checkbox"/> | please complete section (B) |
| iv other (for example a statutory corporation) | <input type="checkbox"/> | please complete section (B) |
| c) a recognised club | <input type="checkbox"/> | please complete section (B) |
| d) a charity | <input type="checkbox"/> | please complete section (B) |

- e) the proprietor of an educational establishment ☐ please complete section (B)
- f) a health service body ☐ please complete section (B)
- g) a person who is registered under Part 2 of the Care Standards Act 2000 (c14) in respect of an independent hospital in Wales ☐ please complete section (B)
- ga) a person who is registered under Chapter 2 of Part 1 of the Health and Social Care Act 2008 (within the meaning of that Part) in an independent hospital in England ☐ please complete section (B)
- h) the chief officer of police of a police force in England and Wales ☐ please complete section (B)

* If you are applying as a person described in (a) or (b) please confirm (by ticking yes to one box below):

I am carrying on or proposing to carry on a business which involves the use of the premises for licensable activities; or ☒

I am making the application pursuant to a statutory function or ☐

a function discharged by virtue of Her Majesty's prerogative ☐

(A) INDIVIDUAL APPLICANTS (fill in as applicable)

| | | | | | |
|--|------------------------------|--|-----------------------------|--------------------------------|--|
| Mr <input type="checkbox"/> | Mrs <input type="checkbox"/> | Miss <input type="checkbox"/> | Ms <input type="checkbox"/> | Other Title (for example, Rev) | |
| Surname | | | First names | | |
| Date of birth | | I am 18 years old or over <input type="checkbox"/> | | Please tick yes | |
| Nationality | | | | | |
| Current residential address if different from premises address | | | | | |
| Post town | | | | Postcode | |
| Daytime contact telephone number | | | | | |
| E-mail address (optional) | | | | | |

SECOND INDIVIDUAL APPLICANT (if applicable)

| | | | | | |
|---|------------------------------|-------------------------------|--|--------------------------------|--|
| Mr <input type="checkbox"/> | Mrs <input type="checkbox"/> | Miss <input type="checkbox"/> | Ms <input type="checkbox"/> | Other Title (for example, Rev) | |
| Surname | | | First names | | |
| Date of birth | | | I am 18 years old or over <input type="checkbox"/> Please tick yes | | |
| Nationality | | | | | |
| Current postal address if different from premises address | | | | | |
| Post town | | | | Postcode | |
| Daytime contact telephone number | | | | | |
| E-mail address (optional) | | | | | |

(B) OTHER APPLICANTS

Please provide name and registered address of applicant in full. Where appropriate please give any registered number. In the case of a partnership or other joint venture (other than a body corporate), please give the name and address of each party concerned.

| |
|---|
| Name Brewskee Limited |
| Address 64 NEW CAVENDISH STREET LONDON W1G 8TB |
| Registered number (where applicable)  |
| Description of applicant (for example, partnership, company, unincorporated association etc.) Company |
| Telephone number (if any) |
| E-mail address (optional) |

Part 3 Operating Schedule

When do you want the premises licence to start?

| DD | | MM | | YYYY | | | |
|----|---|----|---|------|---|---|---|
| 0 | 1 | 0 | 8 | 2 | 0 | 1 | 7 |

If you wish the licence to be valid only for a limited period, when do you want it to end?

| DD | | MM | | YYYY | | | |
|----|---|----|---|------|---|---|---|
| 1 | 1 | 1 | 1 | 1 | 1 | 1 | 1 |

Please give a general description of the premises (please read guidance note 1)

Indoor games facility with ancillary bars and provision for substantial food

If 5,000 or more people are expected to attend the premises at any one time, please state the number expected to attend.

What licensable activities do you intend to carry on from the premises?

(please see sections 1 and 14 and Schedules 1 and 2 to the Licensing Act 2003)

Provision of regulated entertainment (please read guidance note 2)

Please tick all that apply

- a) plays (if ticking yes, fill in box A) ☐
- b) films (if ticking yes, fill in box B) ☐
- c) indoor sporting events (if ticking yes, fill in box C) ☐
- d) boxing or wrestling entertainment (if ticking yes, fill in box D) ☐
- e) live music (if ticking yes, fill in box E) ☒
- f) recorded music (if ticking yes, fill in box F) ☒
- g) performances of dance (if ticking yes, fill in box G) ☐
- h) anything of a similar description to that falling within (e), (f) or (g) (if ticking yes, fill in box H) ☐

Provision of late night refreshment (if ticking yes, fill in box I)

[✓]

Supply of alcohol (if ticking yes, fill in box J)

[✓]

In all cases complete boxes K, L and M

A

| | | | | | | |
|---|-------|--------|---|--|----------|--------------------------|
| Plays Standard days and timings (please read guidance note 7) | | | <u>Will the performance of a play take place indoors or outdoors or both – please tick</u> (please read guidance note 3) | | Indoors | <input type="checkbox"/> |
| | | | | | Outdoors | <input type="checkbox"/> |
| | | | | | Both | <input type="checkbox"/> |
| Day | Start | Finish | <u>Please give further details here</u> (please read guidance note 4) | | | |
| Mon | | | | | | |
| | | | | | | |
| Tue | | | | | | |
| Wed | | | <u>State any seasonal variations for performing plays</u> (please read guidance note 5) | | | |
| | | | | | | |
| Thur | | | | | | |
| | | | | | | |
| Fri | | | <u>Non standard timings. Where you intend to use the premises for the performance of plays at different times to those listed in the column on the left, please list</u> (please read guidance note 6) | | | |
| | | | | | | |
| Sat | | | | | | |
| | | | | | | |
| Sun | | | | | | |
| | | | | | | |

B

| | | | | | |
|---|-------|--------|--|----------|--------------------------|
| Films Standard days and timings (please read guidance note 7) | | | <u>Will the exhibition of films take place indoors or outdoors or both – please tick</u> (please read guidance note 3) | Indoors | <input type="checkbox"/> |
| | | | | Outdoors | <input type="checkbox"/> |
| | | | | Both | <input type="checkbox"/> |
| Day | Start | Finish | | | |
| Mon | | | <u>Please give further details here</u> (please read guidance note 4) | | |
| | | | | | |
| Tue | | | | | |
| | | | | | |
| Wed | | | <u>State any seasonal variations for the exhibition of films</u> (please read guidance note 5) | | |
| | | | | | |
| Thur | | | | | |
| | | | | | |
| Fri | | | <u>Non standard timings. Where you intend to use the premises for the exhibition of films at different times to those listed in the column on the left, please list</u> (please read guidance note 6) | | |
| | | | | | |
| Sat | | | | | |
| | | | | | |
| Sun | | | | | |

C

| | | | |
|--|-------|--------|--|
| Indoor sporting events Standard days and timings (please read guidance note 7) | | | <u>Please give further details</u> (please read guidance note 4) |
| Day | Start | Finish | |
| Mon | | | |
| Tue | | | <u>State any seasonal variations for indoor sporting events</u> (please read guidance note 5) |
| Wed | | | |
| Thur | | | |
| Fri | | | <u>Non standard timings. Where you intend to use the premises for indoor sporting events at different times to those listed in the column on the left, please list</u> (please read guidance note 6) |
| Sat | | | |
| Sun | | | |

D

| | | | | | |
|---|-------|--------|--|----------|--------------------------|
| Boxing or wrestling entertainments Standard days and timings (please read guidance note 7) | | | <u>Will the boxing or wrestling entertainment take place indoors or outdoors or both – please tick</u> (please read guidance note 3) | Indoors | <input type="checkbox"/> |
| | | | | Outdoors | <input type="checkbox"/> |
| Day | Start | Finish | | Both | <input type="checkbox"/> |
| Mon | | | <u>Please give further details here</u> (please read guidance note 4) | | |
| | | | | | |
| Tue | | | | | |
| | | | | | |
| Wed | | | <u>State any seasonal variations for boxing or wrestling entertainment</u> (please read guidance note 5) | | |
| | | | | | |
| Thur | | | | | |
| | | | | | |
| Fri | | | <u>Non standard timings. Where you intend to use the premises for boxing or wrestling entertainment at different times to those listed in the column on the left, please list</u> (please read guidance note 6) | | |
| | | | | | |
| Sat | | | | | |
| | | | | | |
| Sun | | | | | |
| | | | | | |

E

| | | | | | |
|--|-------|--------|---|--|---|
| Live music Standard days and timings (please read guidance note 7) | | | Will the performance of live music take place indoors or outdoors or both – please tick (please read guidance note 3) | | Indoors <input checked="" type="checkbox"/> |
| | | | | | Outdoors <input type="checkbox"/> |
| | | | | | Both <input type="checkbox"/> |
| Day | Start | Finish | Please give further details here (please read guidance note 4) | | |
| Mon | 23.00 | 01.00 | | | |
| | | | | | |
| Tue | 23.00 | 01.00 | | | |
| | | | | | |
| Wed | 23.00 | 01.00 | State any seasonal variations for the performance of live music (please read guidance note 5) | | |
| | | | | | |
| Thur | 23.00 | 02.00 | | | |
| | | | | | |
| Fri | 23.00 | 02.00 | Non standard timings. Where you intend to use the premises for the performance of live music at different times to those listed in the column on the left, please list (please read guidance note 6) | | |
| | | | | | |
| Sat | 23.00 | 02.00 | | | |
| | | | | | |
| Sun | 23.00 | 00.00 | | | |
| | | | | | |

F

| | | | | | | |
|--|-------|--------|---|--|----------|-------------------------------------|
| Recorded music Standard days and timings (please read guidance note 7) | | | Will the playing of recorded music take place indoors or outdoors or both – please tick (please read guidance note 3) | | Indoors | <input checked="" type="checkbox"/> |
| | | | | | Outdoors | <input type="checkbox"/> |
| | | | | | Both | <input type="checkbox"/> |
| Day | Start | Finish | Please give further details here (please read guidance note 4) | | | |
| Mon | 23.00 | 01.00 | | | | |
| | | | | | | |
| Tue | 23.00 | 01.00 | | | | |
| | | | State any seasonal variations for the playing of recorded music (please read guidance note 5) | | | |
| Wed | 23.00 | 01.00 | | | | |
| | | | | | | |
| Thur | 23.00 | 02.00 | | | | |
| | | | Non standard timings. Where you intend to use the premises for the playing of recorded music at different times to those listed in the column on the left, please list (please read guidance note 6) | | | |
| Fri | 23.00 | 02.00 | | | | |
| | | | | | | |
| Sat | 23.00 | 02.00 | | | | |
| | | | | | | |
| Sun | 23.00 | 00.00 | | | | |
| | | | | | | |

G

| | | | | | |
|---|-------|--------|---|----------|--------------------------|
| Performances of dance Standard days and timings (please read guidance note 7) | | | <u>Will the performance of dance take place indoors or outdoors or both – please tick</u> (please read guidance note 3) | Indoors | <input type="checkbox"/> |
| | | | | Outdoors | <input type="checkbox"/> |
| | | | | Both | <input type="checkbox"/> |
| Day | Start | Finish | <u>Please give further details here</u> (please read guidance note 4) | | |
| Mon | | | | | |
| | | | | | |
| Tue | | | | | |
| | | | <u>State any seasonal variations for the performance of dance</u> (please read guidance note 5) | | |
| Wed | | | | | |
| | | | | | |
| Thur | | | | | |
| | | | <u>Non standard timings. Where you intend to use the premises for the performance of dance at different times to those listed in the column on the left, please list</u> (please read guidance note 6) | | |
| Fri | | | | | |
| | | | | | |
| Sat | | | | | |
| | | | | | |
| Sun | | | | | |

H

| | | | | | |
|--|-------|--------|--|----------|--------------------------|
| Anything of a similar description to that falling within (e), (f) or (g) Standard days and timings (please read guidance note 7) | | | Please give a description of the type of entertainment you will be providing | | |
| Day | Start | Finish | <u>Will this entertainment take place indoors or outdoors or both – please tick</u> (please read guidance note 3) | Indoors | <input type="checkbox"/> |
| Mon | | | | Outdoors | <input type="checkbox"/> |
| | | | | Both | <input type="checkbox"/> |
| Tue | | | <u>Please give further details here</u> (please read guidance note 4) | | |
| Wed | | | | | |
| Thur | | | <u>State any seasonal variations for entertainment of a similar description to that falling within (e), (f) or (g)</u> (please read guidance note 5) | | |
| Fri | | | | | |
| Sat | | | <u>Non standard timings. Where you intend to use the premises for the entertainment of a similar description to that falling within (e), (f) or (g) at different times to those listed in the column on the left, please list</u> (please read guidance note 6) | | |
| Sun | | | | | |

I

| | | | | | |
|--|-------|--------|---|----------|-------------------------------------|
| Late night refreshment Standard days and timings (please read guidance note 7) | | | Will the provision of late night refreshment take place indoors or outdoors or both – please tick (please read guidance note 3) | Indoors | <input checked="" type="checkbox"/> |
| | | | | Outdoors | <input type="checkbox"/> |
| | | | | Both | <input type="checkbox"/> |
| Day | Start | Finish | <u>Please give further details here</u> (please read guidance note 4) | | |
| Mon | 23.00 | 01.00 | | | |
| | | | | | |
| Tue | 23.00 | 01.00 | | | |
| | | | <u>State any seasonal variations for the provision of late night refreshment</u> (please read guidance note 5) | | |
| Wed | 23.00 | 01.00 | | | |
| | | | | | |
| Thur | 23.00 | 02.00 | | | |
| | | | <u>Non standard timings. Where you intend to use the premises for the provision of late night refreshment at different times, to those listed in the column on the left, please list</u> (please read guidance note 6) | | |
| Fri | 23.00 | 02.00 | | | |
| | | | | | |
| Sat | 23.00 | 02.00 | | | |
| | | | | | |
| Sun | 23.00 | 00.00 | | | |
| | | | | | |

J

| | | | | | |
|---|-------|--------|---|------------------|-------------------------------------|
| Supply of alcohol Standard days and timings (please read guidance note 7) | | | Will the supply of alcohol be for consumption – please tick (please read guidance note 8) | On the premises | <input checked="" type="checkbox"/> |
| | | | | Off the premises | <input type="checkbox"/> |
| Day | Start | Finish | | Both | <input type="checkbox"/> |
| Mon | 11.00 | 01.00 | State any seasonal variations for the supply of alcohol (please read guidance note 5) | | |
| | | | | | |
| Tue | 11.00 | 01.00 | | | |
| | | | | | |
| Wed | 11.00 | 01.00 | | | |
| | | | | | |
| Thur | 11.00 | 02.00 | Non standard timings. Where you intend to use the premises for the supply of alcohol at different times to those listed in the column on the left, please list (please read guidance note 6) | | |
| | | | | | |
| Fri | 11.00 | 02.00 | | | |
| | | | | | |
| Sat | 11.00 | 02.00 | | | |
| | | | | | |
| Sun | 11.00 | 00.00 | | | |
| | | | | | |

State the name and details of the individual whom you wish to specify on the licence as designated premises supervisor (Please see declaration about the entitlement to work in the checklist at the end of the form):

| | |
|---|---------|
| Name Tristan Hoffman | |
| Date of birth [REDACTED] | |
| Address Patio Flat [REDACTED] Ventnor Villas Hove | |
| Postcode | BN3 3DA |
| Personal licence number (if known) [REDACTED] | |
| Issuing licensing authority (if known) Brighton & Hove Council | |

Please highlight any adult entertainment or services, activities, other entertainment or matters ancillary to the use of the premises that may give rise to concern in respect of children (please read guidance note 9).

L

State any seasonal variations (please read guidance note 5)

M Describe the steps you intend to take to promote the four licensing objectives:

a) General – all four licensing objectives (b, c, d and e) (please read guidance note 10)

The Premises will operate as a bar and restaurant with food being available throughout the premises at all times and with games available to play at all times.

b) The prevention of crime and disorder

The premises will install and maintain a comprehensive digital colour CCTV system. All public areas of the licensed premises will be covered enabling frontal identification of every person entering in any light condition. The CCTV cameras will continually record whilst the premises are open to the public and recordings will be kept available for a minimum of 31 days with date and time stamping. A staff member who is conversant with the operation of the CCTV system will be present at all times when they are open to the public. This staff member will be able to show the police or the Licensing Authority recordings of the preceding two days immediately when requested.

There will be no promoted events, where a promoted event means an event involving music and/or dancing where the musical entertainment is provided at any time by a DJ or DJs, one or some of whom are not employees of the premises licence holder and the event is promoted to the general public.

c) Public safety

Health and safety risk assessments will be undertaken and all staff shall be trained therein

d) The prevention of public nuisance

All appropriate steps will be taken to ensure that local residents and local businesses are not disturbed by any licensable activity at the premises.

Waiting staff will continually exercise supervision throughout the premises.

Notices shall be prominently displayed to remind patrons that they are leaving premises with residential neighbours.

e) The protection of children from harm

All persons under the age of 16 will be accompanied by an adult on the premises at all times.
All staff will be trained in relation to their responsibilities towards children under the
Licensing Act 2003

Checklist:

Please tick to indicate agreement

- I have made or enclosed payment of the fee. ☒
- I have enclosed the plan of the premises. ☒
- I have sent copies of this application and the plan to responsible authorities and others where applicable. ☒
- I have enclosed the consent form completed by the individual I wish to be designated premises supervisor, if applicable. ☒
- I understand that I must now advertise my application. ☒
- I understand that if I do not comply with the above requirements my application will be rejected. ☒
- ☐
[Applicable to all individual applicants, including those in a partnership which is not a limited liability partnership, but not companies or limited liability partnerships] I have included documents demonstrating my entitlement to work in the United Kingdom (please read note 15).

IT IS AN OFFENCE, UNDER SECTION 158 OF THE LICENSING ACT 2003, TO MAKE A FALSE STATEMENT IN OR IN CONNECTION WITH THIS APPLICATION. THOSE WHO MAKE A FALSE STATEMENT MAY BE LIABLE ON SUMMARY CONVICTION TO A FINE OF ANY AMOUNT.

IT IS AN OFFENCE UNDER SECTION 24B OF THE IMMIGRATION ACT 1971 FOR A PERSON TO WORK WHEN THEY KNOW, OR HAVE REASONABLE CAUSE TO BELIEVE, THAT THEY ARE DISQUALIFIED FROM DOING SO BY REASON OF THEIR IMMIGRATION STATUS. THOSE WHO EMPLOY AN ADULT WITHOUT LEAVE OR WHO IS SUBJECT TO CONDITIONS AS TO EMPLOYMENT WILL BE LIABLE TO A CIVIL PENALTY UNDER SECTION 15 OF THE IMMIGRATION, ASYLUM AND NATIONALITY ACT 2006 AND PURSUANT TO SECTION 21 OF THE SAME ACT, WILL BE COMMITTING AN OFFENCE WHERE THEY DO SO IN THE KNOWLEDGE, OR WITH REASONABLE CAUSE TO BELIEVE, THAT THE EMPLOYEE IS DISQUALIFIED.

Part 4 – Signatures (please read guidance note 11)

Signature of applicant or applicant's solicitor or other duly authorised agent (see guidance note 12). If signing on behalf of the applicant, please state in what capacity.

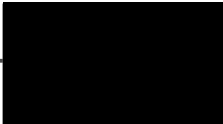
| | |
|--------------------|---|
| Declaration | <ul style="list-style-type: none">• [Applicable to individual applicants only, including those in a partnership which is not a limited liability partnership] I understand I am not entitled to be issued with a licence if I do not have the entitlement to live and work in the UK (or if I am subject to a condition preventing me from doing work relating to the carrying on of a licensable activity) and that my licence will become invalid if I cease to be entitled to live and work in the UK (please read guidance note 15).• The DPS named in this application form is entitled to work in the UK (and is not subject to conditions preventing him or her from doing work relating to a licensable activity) and I have seen a copy of his or her proof of entitlement to work, if appropriate (please see note 15) |
| Signature |  |
| Date | 20 June 2017 |
| Capacity | Solicitors for the applicant |

For joint applications, signature of 2nd applicant or 2nd applicant's solicitor or other authorised agent (please read guidance note 13). If signing on behalf of the applicant, please state in what capacity.

| | |
|-----------|--|
| Signature | |
| Date | |
| Capacity | |

| | | | |
|---|---------------|----------|----------|
| Contact name (where not previously given) and postal address for correspondence associated with this application (please read guidance note 14) Craig Baylis BLP Adelaide House London Bridge | | | |
| Post town | London | Postcode | EC4R 9HA |
| Telephone number (if any) | 0203 400 2326 | | |
| If you would prefer us to correspond with you by e-mail, your e-mail address (optional)  | | | |

Notes for Guidance

1. Describe the premises, for example the type of premises, its general situation and layout and any other information which could be relevant to the licensing objectives. Where your application includes off-supplies of alcohol and you intend to provide a place for consumption of these off-supplies, you must include a description of where the place will be and its proximity to the premises.
2. In terms of specific regulated entertainments please note that:
 - Plays: no licence is required for performances between 08:00 and 23.00 on any day, provided that the audience does not exceed 500.
 - Films: no licence is required for 'not-for-profit' film exhibition held in community premises between 08.00 and 23.00 on any day provided that the audience does not exceed 500 and the organiser (a) gets consent to the screening from a person who is responsible for the premises; and (b) ensures that each such screening abides by age classification ratings.
 - Indoor sporting events: no licence is required for performances between 08.00 and 23.00 on any day, provided that the audience does not exceed 1000.
 - Boxing or Wrestling Entertainment: no licence is required for a contest, exhibition or display of Greco-Roman wrestling, or freestyle wrestling between 08.00 and 23.00 on any day, provided that the audience does not exceed 1000. Combined fighting sports – defined as a contest, exhibition or display which combines boxing or wrestling with one or more martial arts – are licensable as a boxing or wrestling entertainment rather than an indoor sporting event.
 - Live music: no licence permission is required for:
 - a performance of unamplified live music between 08.00 and 23.00 on any day, on any premises.
 - a performance of amplified live music between 08.00 and 23.00 on any day on premises authorised to sell alcohol for consumption on those premises, provided that the audience does not exceed 500.
 - a performance of amplified live music between 08.00 and 23.00 on any day, in a workplace that is not licensed to sell alcohol on those premises, provided that the audience does not exceed 500.
 - a performance of amplified live music between 08.00 and 23.00 on any day, in a church hall, village hall, community hall, or other similar community premises, that is not licensed by a premises licence to sell alcohol, provided that (a) the audience does not exceed 500, and (b) the organiser gets consent for the performance from a person who is responsible for the premises.
 - a performance of amplified live music between 08.00 and 23.00 on any day, at the non-residential premises of (i) a local authority, or (ii) a school, or (iii) a hospital, provided that (a) the audience does not exceed 500, and (b) the organiser gets consent for the performance on the relevant premises from: (i) the local authority concerned, or (ii) the school or (iii) the health care provider for the hospital.
 - Recorded Music: no licence permission is required for:
 - any playing of recorded music between 08.00 and 23.00 on any day on premises authorised to sell alcohol for consumption on those premises, provided that the audience does not exceed 500.
 - any playing of recorded music between 08.00 and 23.00 on any day, in a church hall, village hall, community hall, or other similar community premises, that is not licensed by a premises licence to sell alcohol, provided that (a) the audience does not exceed 500, and (b) the organiser gets consent for the performance from a person who is responsible for the premises.
 - any playing of recorded music between 08.00 and 23.00 on any day, at the non-residential premises of (i) a local authority, or (ii) a school, or (iii) a hospital, provided that (a) the audience does not exceed 500, and

(b) the organiser gets consent for the performance on the relevant premises from: (i) the local authority concerned, or (ii) the school proprietor or (iii) the health care provider for the hospital.

- Dance: no licence is required for performances between 08.00 and 23.00 on any day, provided that the audience does not exceed 500. However, a performance which amounts to adult entertainment remains licensable.
 - Cross activity exemptions: no licence is required between 08.00 and 23.00 on any day, with no limit on audience size for:
 - any entertainment taking place on the premises of the local authority where the entertainment is provided by or on behalf of the local authority;
 - any entertainment taking place on the hospital premises of the health care provider where the entertainment is provided by or on behalf of the health care provider;
 - any entertainment taking place on the premises of the school where the entertainment is provided by or on behalf of the school proprietor; and
 - any entertainment (excluding films and a boxing or wrestling entertainment) taking place at a travelling circus, provided that (a) it takes place within a moveable structure that accommodates the audience, and (b) that the travelling circus has not been located on the same site for more than 28 consecutive days.
3. Where taking place in a building or other structure please tick as appropriate (indoors may include a tent).
 4. For example the type of activity to be authorised, if not already stated, and give relevant further details, for example (but not exclusively) whether or not music will be amplified or unamplified.
 5. For example (but not exclusively), where the activity will occur on additional days during the summer months.
 6. For example (but not exclusively), where you wish the activity to go on longer on a particular day e.g. Christmas Eve.
 7. Please give timings in 24 hour clock (e.g. 16.00) and only give details for the days of the week when you intend the premises to be used for the activity.
 8. If you wish people to be able to consume alcohol on the premises, please tick 'on the premises'. If you wish people to be able to purchase alcohol to consume away from the premises, please tick 'off the premises'. If you wish people to be able to do both, please tick 'both'.
 9. Please give information about anything intended to occur at the premises or ancillary to the use of the premises which may give rise to concern in respect of children, regardless of whether you intend children to have access to the premises, for example (but not exclusively) nudity or semi-nudity, films for restricted age groups or the presence of gaming machines.
 10. Please list here steps you will take to promote all four licensing objectives together.
 11. The application form must be signed.
 12. An applicant's agent (for example solicitor) may sign the form on their behalf provided that they have actual authority to do so.
 13. Where there is more than one applicant, each of the applicants or their respective agent must sign the application form.
 14. This is the address which we shall use to correspond with you about this application.

15. Entitlement to work/immigration status for individual applicants and applications from partnerships which are not limited liability partnerships:

A licence may not be held by an individual or an individual in a partnership who is resident in the UK who:

- does not have the right to live and work in the UK; or

- is subject to a condition preventing him or her from doing work relating to the carrying on of a licensable activity.

Any premises licence issued in respect of an application made on or after 6 April 2017 will become invalid if the holder ceases to be entitled to work in the UK.

Applicants must demonstrate that they have an entitlement to work in the UK and are not subject to a condition preventing them from doing work relating to the carrying on of a licensable activity. They do this by providing with this application copies or scanned copies of the following documents (which do not need to be certified).

Documents which demonstrate entitlement to work in the UK

- An expired or current passport showing the holder, or a person named in the passport as the child of the holder, is a British citizen or a citizen of the UK and Colonies having the right of abode in the UK [please see note below about which sections of the passport to copy].
- An expired or current passport or national identity card showing the holder, or a person named in the passport as the child of the holder, is a national of a European Economic Area country or Switzerland.
- A Registration Certificate or document certifying permanent residence issued by the Home Office to a national of a European Economic Area country or Switzerland.
- A Permanent Residence Card issued by the Home Office to the family member of a national of a European Economic Area country or Switzerland.
- A **current** Biometric Immigration Document (Biometric Residence Permit) issued by the Home Office to the holder indicating that the person named is allowed to stay indefinitely in the UK, or has no time limit on their stay in the UK.
- A **current** passport endorsed to show that the holder is exempt from immigration control, is allowed to stay indefinitely in the UK, has the right of abode in the UK, or has no time limit on their stay in the UK.
- A **current** Immigration Status Document issued by the Home Office to the holder with an endorsement indicating that the named person is allowed to stay indefinitely in the UK or has no time limit on their stay in the UK, **when produced in combination with** an official document giving the person's permanent National Insurance number and their name issued by a Government agency or a previous employer.
- A **full** birth or adoption certificate issued in the UK which includes the name(s) of at least one of the holder's parents or adoptive parents, **when produced in combination with** an official document giving the person's permanent National Insurance number and their name issued by a Government agency or a previous employer.
- A birth or adoption certificate issued in the Channel Islands, the Isle of Man or Ireland **when produced in combination with** an official document giving the person's permanent National Insurance number and their name issued by a Government agency or a previous employer.

- A certificate of registration or naturalisation as a British citizen, **when produced in combination with** an official document giving the person's permanent National Insurance number and their name issued by a Government agency or a previous employer.
- A **current** passport endorsed to show that the holder is allowed to stay in the UK and is currently allowed to work and is not subject to a condition preventing the holder from doing work relating to the carrying on of a licensable activity.
- A **current** Biometric Immigration Document (Biometric Residence Permit) issued by the Home Office to the holder which indicates that the named person can currently stay in the UK and is allowed to work relation to the carrying on of a licensable activity.
- A **current** Residence Card issued by the Home Office to a person who is not a national of a European Economic Area state or Switzerland but who is a family member of such a national or who has derivative rights or residence.
- A **current** Immigration Status Document containing a photograph issued by the Home Office to the holder with an endorsement indicating that the named person may stay in the UK, and is allowed to work and is not subject to a condition preventing the holder from doing work relating to the carrying on of a licensable activity **when produced in combination with** an official document giving the person's permanent National Insurance number and their name issued by a Government agency or a previous employer.
- A Certificate of Application, **less than 6 months old**, issued by the Home Office under regulation 17(3) or 18A (2) of the Immigration (European Economic Area) Regulations 2006, to a person who is not a national of a European Economic Area state or Switzerland but who is a family member of such a national or who has derivative rights of residence.
- Reasonable evidence that the person has an outstanding application to vary their permission to be in the UK with the Home Office such as the Home Office acknowledgement letter or proof of postage evidence, or reasonable evidence that the person has an appeal or administrative review pending on an immigration decision, such as an appeal or administrative review reference number.
- Reasonable evidence that a person who is not a national of a European Economic Area state or Switzerland but who is a family member of such a national or who has derivative rights of residence in exercising treaty rights in the UK including:-
 - evidence of the applicant's own identity – such as a passport,
 - evidence of their relationship with the European Economic Area family member – e.g. a marriage certificate, civil partnership certificate or birth certificate, and
 - evidence that the European Economic Area national has a right of permanent residence in the UK or is one of the following if they have been in the UK for more than 3 months:
 - (i) working e.g. employment contract, wage slips, letter from the employer,
 - (ii) self-employed e.g. contracts, invoices, or audited accounts with a bank,
 - (iii) studying e.g. letter from the school, college or university and evidence of sufficient funds; or
 - (iv) self-sufficient e.g. bank statements.

Family members of European Economic Area nationals who are studying or financially independent must also provide evidence that the European Economic Area national and any family members hold comprehensive sickness insurance in the UK. This can include a private medical insurance policy, an EHIC card or an S1, S2 or S3 form.

Original documents must not be sent to licensing authorities. If the document copied is a passport, a copy of the following pages should be provided:-

- (i) any page containing the holder's personal details including nationality;
- (ii) any page containing the holder's photograph;
- (iii) any page containing the holder's signature;
- (iv) any page containing the date of expiry; and
- (v) any page containing information indicating the holder has permission to enter or remain in the UK and is permitted to work.

If the document is not a passport, a copy of the whole document should be provided.

Your right to work will be checked as part of your licensing application and this could involve us checking your immigration status with the Home Office. We may otherwise share information with the Home Office. Your licence application will not be determined until you have complied with this guidance.

Brewskee – 56 Leadenhall Street
Conditions Consistent with the Operating Schedule

1. The premises will install and maintain a comprehensive digital colour CCTV system. All public areas of the licensed premises will be covered enabling facial identification of every person entering in any light condition. The CCTV cameras shall continually record whilst the premises is open for licensable activities and during all times customers remain on the premises. All recordings shall be stored for a minimum period of 31 days with date and time stamping. A staff member who is conversant with the operation of the CCTV system shall be present on the premises at all times when they are open to the public. This staff member shall be able to show the police or the Licensing Authority recent data or footage with the absolute minimum of delay when requested. (MC01)
2. There shall be no promoted events on the premises. A promoted event is an event involving music and/or dancing where the musical entertainment is provided at any time between 23:00 and 07:00 by a disc jockey or disc jockeys one or some of whom are not employees of the premises licence holder and the event is promoted to the general public. (MC02)
3. Prominent signage shall be displayed at all exits from the premises requesting that customers leave quietly. (MC16)
4. Children under the age of 16 years shall not be allowed on the premises unless accompanied by an adult. (MC22)

This page is intentionally left blank

 Creechurch Lane
London
EC3A 5AY

City of London Licensing Authority
Walbrook Wharf
78-83 Upper Thames Street
London
EC4R 3TD
Dear Sir

18 July 2017

Dear Sirs,

Ref Planning Applications:

- 1) **Beer & Buns, 20 Bury Street, EC3A 5AX**
- 2) **Brewskee, 56 Leadenhall Street, EC3A 2DX**
- 3) **Bob Bob Exchange, Level 3, The Leadenhall Building, 122 Leadenhall Street, EC3V 4AB**

I am writing to make the following comments/objections regarding the three above-mentioned license applications in our EC3 neighbourhood on the grounds that they contradict licensing objectives - namely prevention of crime/disorder, public safety, prevention of public nuisance and protection of children from harm:

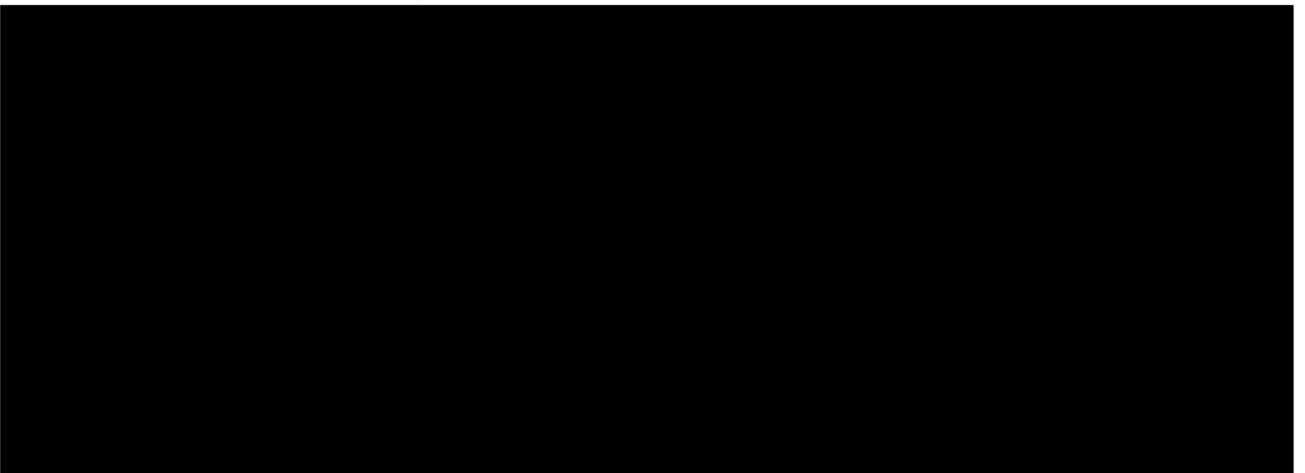

2) Brewskee, 56 Leadenhall Street, EC3A 2DX

This establishment has requested a 2am licence from Thursday to Saturday. It is located right opposite Creechurch Lane, where approximately 50 residential flats are situated.

The existing bars located along Leadenhall Street – namely Pause, Caravaggio and Revolution - have had a long/chequered history of noise disturbance caused to residents, both from amplified music being audible until the early hours and through patrons arriving/departing noisily.

The Brewskee premises will have no designated smoking area and there is no obvious place where one could be provided. The patrons will likely gather on Leadenhall Street to smoke, which is usually accompanied with loud shouting and engaging in antisocial behaviour which will be audible from our flats. The addition of live music also gives cause for concern.

Given that Brewskee Ltd wants to operate all day Saturday and Sunday this will likely bring an end to the quietness we have grown to enjoy, which compensates for the frenzied construction disturbances during the week.

We understand the Brewskee 'indoor games' concept is aimed at corporate customers for team building events. This was probably the intention of Swingers, which has instead attracted a younger 'out of town' demographic, stag/hen groups, tourists clientele – i.e. people who have no kinship/appreciation for the City of London and its historical streets/high quality public realm.

Given the initial corporate concept we cannot understand the need for weekend opening as this is not going to attract the corporate crowd – in addition the logical route from the premises to Liverpool Street Station passes directly outside the residential flats mentioned above, the only real residential area remains in the Aldgate Ward and this would leave the residents without a single undisturbed night from those departing the premises.

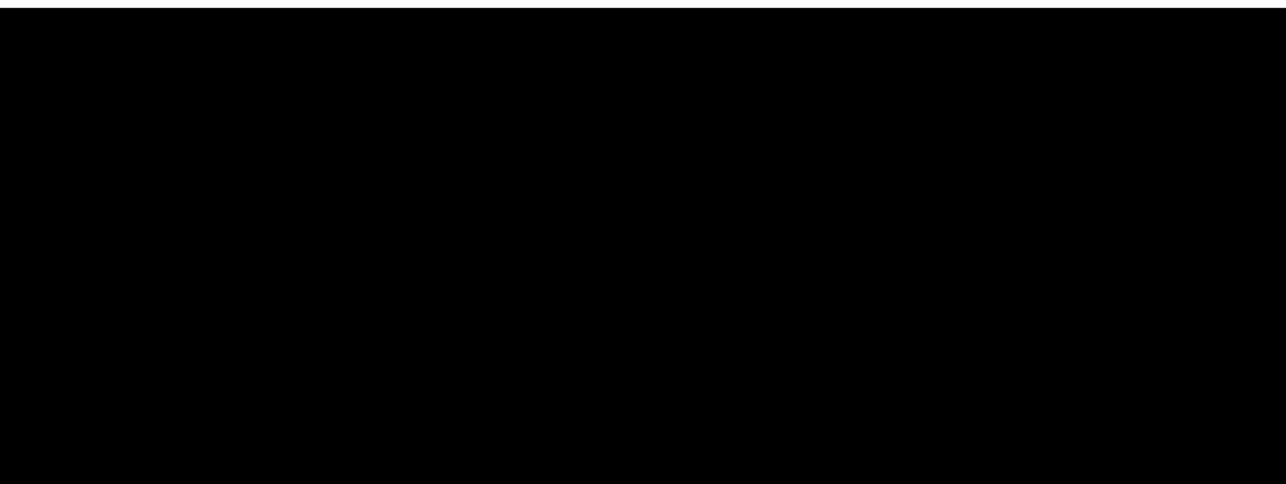

Yours faithfully,

Phyllis Chan

Breese, Robert

From: Yvonne Courtney [REDACTED]
Sent: 16 July 2017 18:52
To: M&CP - Licensing
Cc: Fredericks, Marianne; Lambert, Richard; Marshall, Siobhan
Subject: Bar applications: Beer & Buns, EC3

Dear Sir/Madam,

I am writing to make the following comments/objections with regards to the following three license applications in our EC3 neighbourhood on the grounds that they contradict licensing objectives - namely prevention of crime/disorder, public safety, prevention of public nuisance and protection of children from harm:

[REDACTED]

2) Brewskee, 56 Leadenhall Street, EC3A 2DX

This establishment has requested a 2am licence from Thursday to Saturday. It is located right opposite Creechurch Lane, where approximately 50 flats are situated.

The bars along Leadenhall - Pause, Caravaggio and Revolution - have had a long/chequered history of noise disturbance caused to residents, both from amplified music being audible until the early hours and through patrons arriving/departing noisily.

As the Brewskee premises will have no designated smoking area, patrons will likely gather on Leadenhall Street to smoke, which is usually accompanied with loud shouting and engaging in antisocial behaviour which will be audible from our flats. The addition of live music also gives cause for concern.

Given that Brewskee Ltd wants to operate all day Saturday and Sunday this will likely bring an end to the quiet we have grown to savour which compensates for the frenzied construction disturbances during the week.

We understand the Brewskee 'indoor games' concept is aimed at corporate customers for team building events. This was probably the intention of Swingers, which has instead attracted a younger 'out of town' demographic, stag/hen groups, tourists, etc - ie, people who have no kinship/appreciation for the City of London and its historical streets/high quality public realm.

[REDACTED]

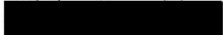

Yours faithfully,
Yvonne Courtney

 Creechurch Lane
EC3A 5AY

Breese, Robert

From: David Rees [REDACTED]
Sent: 16 July 2017 20:32
To: M&CP - Licensing; Fredericks, Marianne; Lambert, Richard; Marshall, Siobhan
Subject: Late night applications in the area surrounding Creechurch Lane EC3.

To:- City of London licensing authority, Walbrook Wharf, 78-83 Upper Thames Street, London EC4R 3TD

To whom it may concern,

It is with some concern that I learn that there have been several applications for late-night venues around the area of my flat.

I understand that they applications are the following:

<https://www.cityoflondon.gov.uk/business/licensing/alcohol-and-entertainment/alcohol-entertainment-applications/Pages/Beer-and-Buns.aspx>

<https://www.cityoflondon.gov.uk/business/licensing/alcohol-and-entertainment/alcohol-entertainment-applications/Pages/Brewskee.aspx>

<https://www.cityoflondon.gov.uk/business/licensing/alcohol-and-entertainment/alcohol-entertainment-applications/Pages/Bob-Bob-Exchange.aspx>

We know from experience that venues are unable to control the early morning noise from their clientele when they leave. This is the most minor issue.

More seriously, we suffer from our courtyard being used as an urinal and, on one occasion even worse, by these late-nighters. I hope that you will appreciate that this is unpleasant in the extreme and something that no-one should have to suffer.

Lastly, and most seriously, it may be recalled that when Caravaggios near us enjoyed a similar late-night licence, there was a death by stabbing. This has lead to the residents feeling very unsafe when returning at night; a situation that we should not have to live through again.

It would be much appreciated if these applications could be rejected because of the inevitable impact on us residents.

Many thanks for any assistance.

Best regards,

David Rees

[REDACTED]
[REDACTED] Creechurch Lane.
London. EC3A 5AY

Sent from Mail for Windows 10

This page is intentionally left blank

City of London Licensing Authority,
Walbrook Wharf,
78-83 Upper Thames Street,
London EC4R 3TD.

16th July 2017

Dear Sir

Ref Planning Applications

- 1) Beer & Buns, 20 Bury Street, EC3A 5AX
- 2) Brewskee, 56 Leadenhall Street, EC3A 2DX
- 2) Bob Bob Exchange, Level 3, The Leadenhall Building, 122 Leadenhall Street, EC3V 4AB

I am writing to make the following comments/objections with regards to the following three license applications in our EC3 neighbourhood on the grounds that they contradict licensing objectives - namely prevention of crime/disorder, public safety, prevention of public nuisance and protection of children from harm:



2) Brewskee, 56 Leadenhall Street, EC3A 2DX

This establishment has requested a 2am licence from Thursday to Saturday. It is located right opposite Creechurch Lane, where approximately 50 flats are situated.

The bars along Leadenhall - Pause, Caravaggio and Revolution - have had a long/chequered history of noise disturbance caused to residents, both from amplified music being audible until the early hours and through patrons arriving/departing noisily.

The Brewskee premises will have no designated smoking area and there is no obvious place where one could be provided. The patrons will likely gather on Leadenhall Street to smoke, which is usually accompanied with loud shouting and engaging in antisocial behaviour which will be audible from our flats. The addition of live music also gives cause for concern.

Given that Brewskee Ltd wants to operate all day Saturday and Sunday this will likely bring an end to the quiet we have grown to savour which compensates for the frenzied construction disturbances during the week.

We understand the Brewskee 'indoor games' concept is aimed at corporate customers for team building events. This was probably the intention of Swingers, which has instead attracted a younger 'out of town' demographic, stag/hen groups, tourists, etc - ie, people who have no kinship/appreciation for the City of London and its historical streets/high quality public realm.

Given the initial corporate concept we cannot understand the need for weekend opening as this is not going to attract the corporate crowd – in addition the logical route from the premises to Liverpool street passes directly passed the flats mentioned above, the only real residential are remaining in the Aldgate Ward and this would leave the residents without a single undisturbed night from those departing the premises.

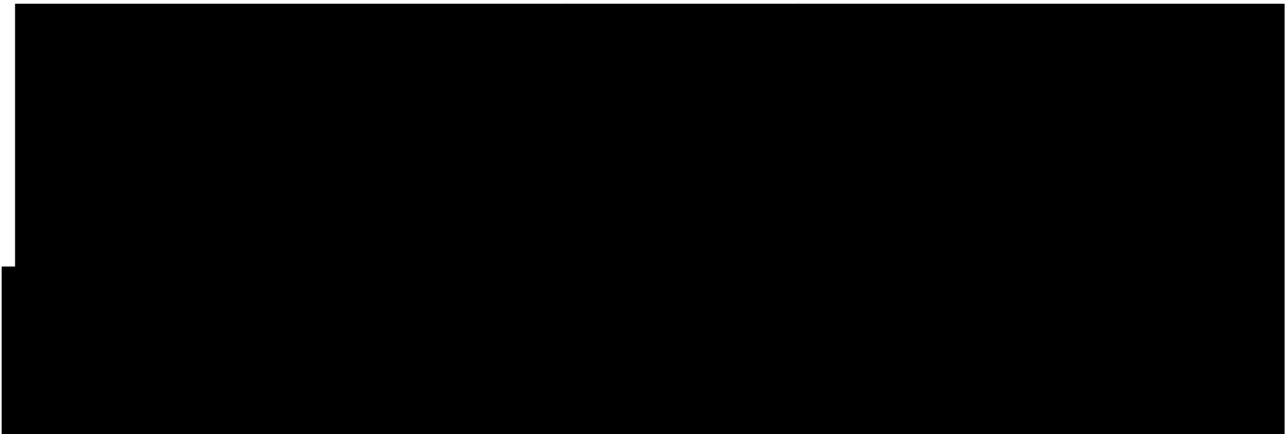

Yours faithfully,

Jonathan Whitby
[REDACTED] The Creechurch
[REDACTED] Creechurch Lane
London
EC3A 5AY

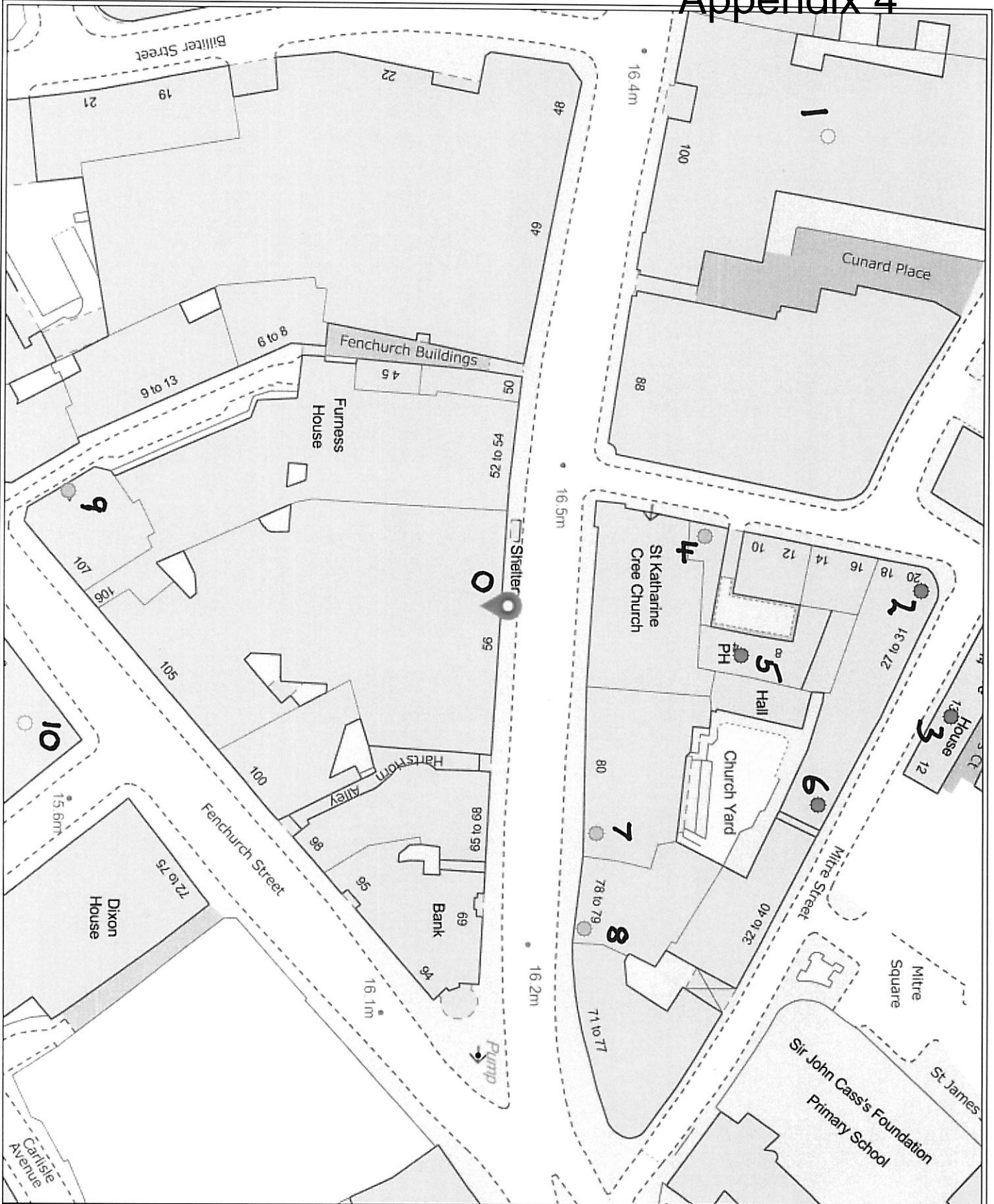

Brewskee
56 Leadenhall Street

- Latest Licensed Activity**
- Up to 23.00
 - 23.01 - 00.00
 - 00.01 - 02.00
 - 02.01 or later
 - 24 hour opening
- City of London Boundary

Created By:

Date Created
31 Jul 2017

0 6 12 25 Metres

© Crown copyright and
database rights 2017 OS
100023243

Brewskee
56 Leadenhall Street
EC3A 5AX

| | <u>Premises</u> | <u>Permitted hours for alcohol sales or other licensable activity with a greater terminal hour</u> |
|----|------------------------------------|---|
| 0 | BREWSKEE | |
| 1 | Ace European Group | 08:00 – 23:00 (23:00 – 00:00)* |
| 2 | Jamies | 11:00 – 23:00 |
| 3 | Adriatico | 10:00 – 23:59 |
| 4 | Anokha | 11:00 – 01:00 |
| 5 | The Old Tea Warehouse | 11:00 – 23:00 |
| 6 | The Craft Beer Company | 07:00 – 23:00 |
| 7 | Pause | 11:00 – 02:00 |
| 8 | Omnino Steak House | 11:00 – 00:00 (23:00 – 01:00)* |
| 9 | Willys Wine Bar | 07:00 – 02:00 |
| 10 | Lloyds Register of Shipping | 09:00 – 00:00 |

* Late Night Refreshment

DRAFT
1-A-5B: Lower ground floor - License plan
(Rev. D 15/06/17)

Key to CCTV

360 deg security camera

Security camera

Key to fire fighting equipment

H2O

2g water extinguisher

CO2

2.5 lb CO2 extinguisher on wall bracket

FM

2g foam extinguisher

BNK

Fire blanket

Key to fire fighting detection warning equipment
To be L1 system

Emergency light fitting

Flame heat sensor

Smoke detector/sounder

Sounder

FPA

Fire panel (addressable)

Escape direction

0

1

2

3

4

5m

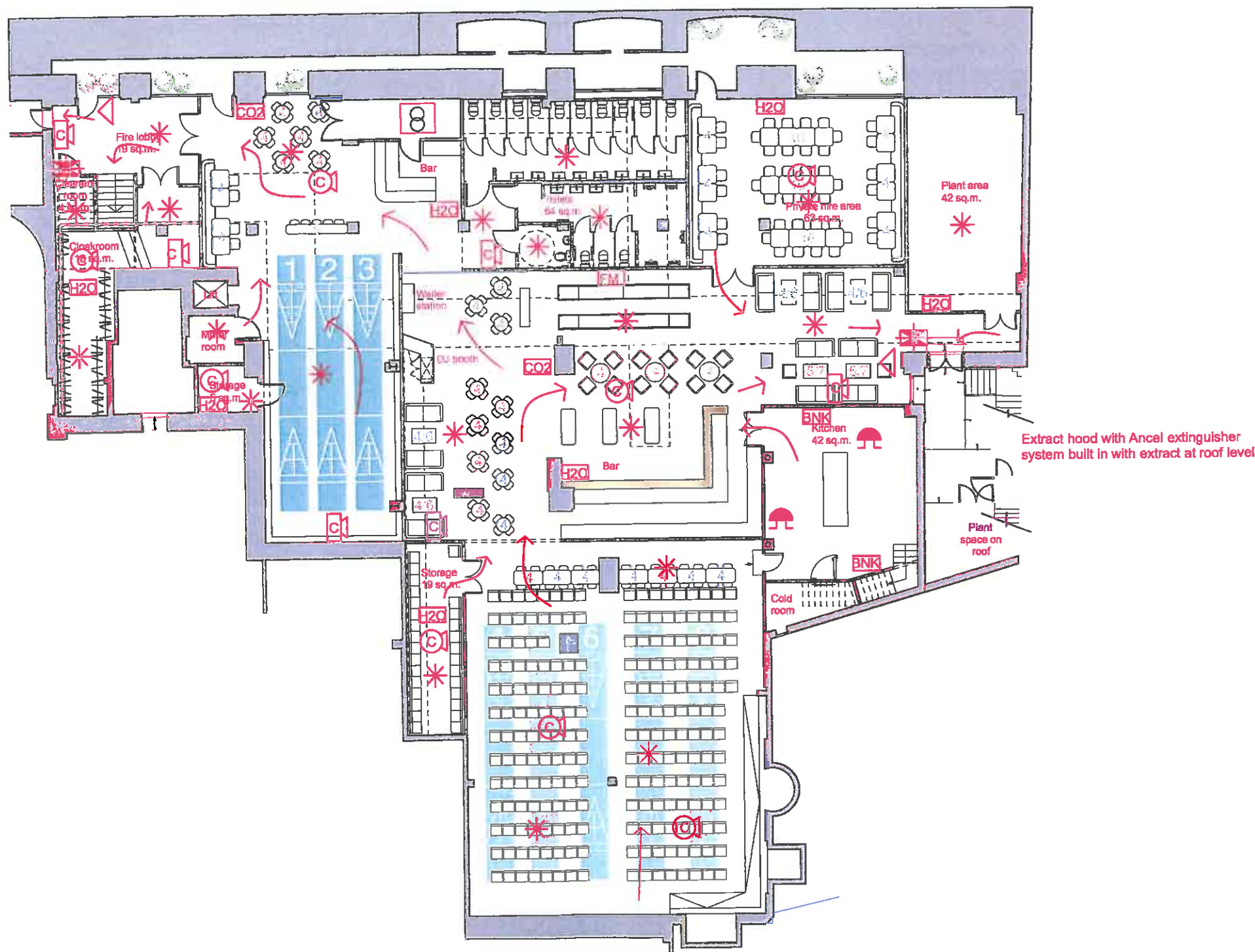

| | | | | | |
|--|-----------------------|--------------------|--|----------------------------|---|
| Project : Brewskee | Scale : 1:200 @ A3 | Dwg no : 1-A-5B | Revision : A 22/04/17 B 22/04/17 C 23/05/17 D 15/06/17 E F | G H I J K L | * Do not scale from drawings. * All dimensions to be checked on site by contractor. * All dimensions remain the responsibility of the contractor. * All designs are the property of Zachary Pulman 2017. |
| Drawing : Lower ground floor - License plan | Units : mm | Status : DRAFT | | | |

DRAFT
1-A-5A: Ground floor - License plan
(Rev. D 15/06/17)

N

Key to CCTV

C

360 deg security camera

c

Security camera

Key to fire fighting equipment

H2O

2g water extinguisher

CO2

2.5 lb CO2 extinguisher on wall bracket

FM

2g foam extinguisher

BNK

Fire blanket

Key to fire fighting detection warning equipment
To be L1 system

P

Emergency light fitting

FHS

Flame heat sensor

SDS

Smoke detector/sounder

S

Sounder

FPA

Fire panel (addressable)

→

Escape direction

Page 46

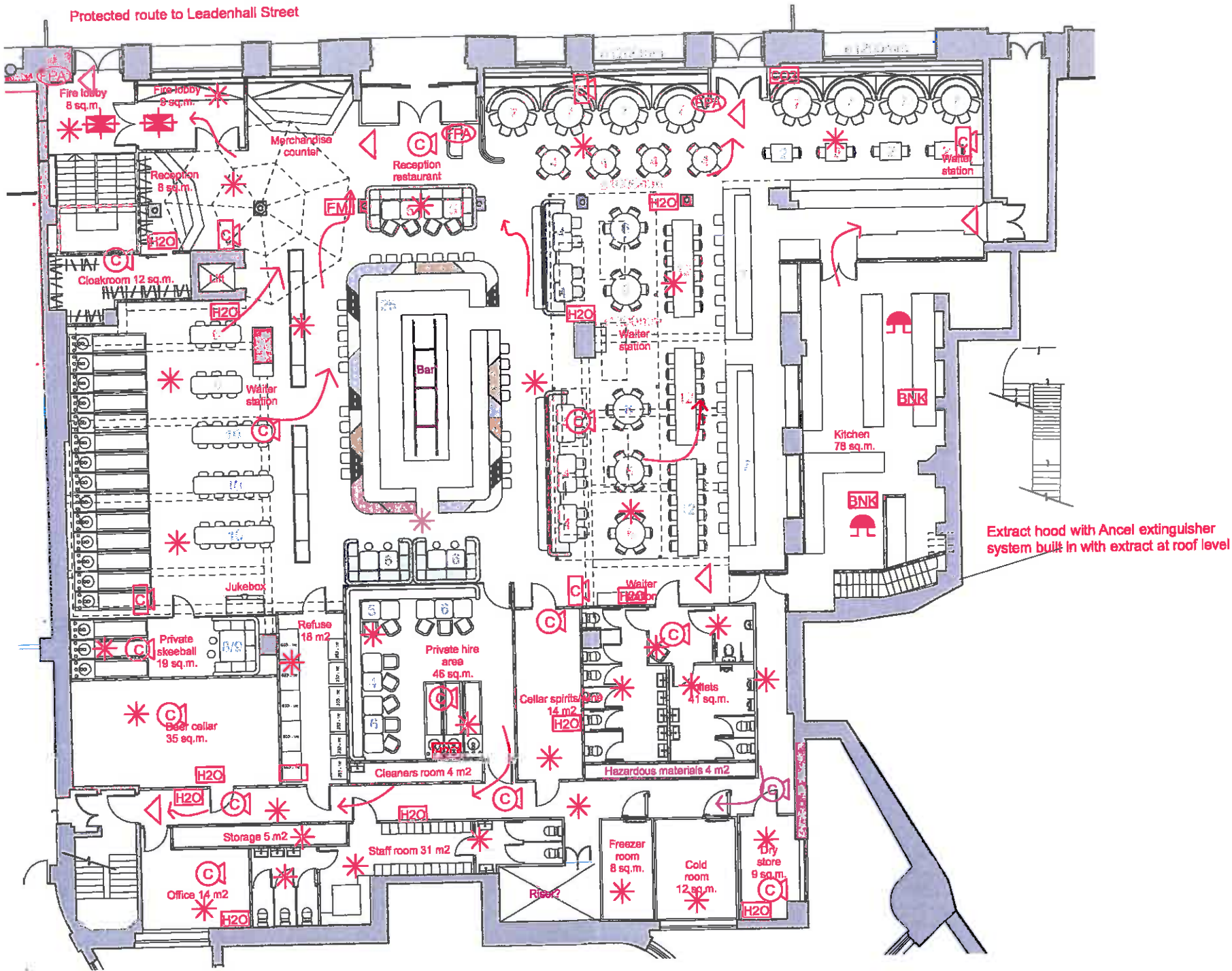

Zachary Pulman Design Consultants
Unit 4 - 7 Wenlock Road, London N1 7SL
www.zacharypulman.com
info@zacharypulman.com

| | | | |
|--|-----------------------|--------------------|--|
| Project : Brewskee | Scale : 1:200 @ A3 | Dwg no : 1-A-5A | Revision : A 20/04/17 B 24/04/17 C 23/05/17 D 15/06/17 E F |
| Drawing : Ground floor - License plan | Units : mm | Status : DRAFT | G H I J K L |

* Do not scale from drawings.
* All dimensions to be checked on site by contractor.
* All dimensions remain the responsibility of the contractor.
* All designs are the property of Zachary Pulman 2017.